

Changing Your Crosskate 616 Backcountry™ Steering Springs

Please refer to the Owner's Manual that came with your skates for other important mechanical, safety, and user information.



The PowerCarve™ system utilizes two springs of different strengths. This design ensures the best steering response. We advise that the springs be at least one strength grade apart. **Yellow**= Light, **Black**= Medium, **Red**=Heavy, **Green**= Xtra Heavy
NOTE: If the steering is too responsive, install stiffer springs. If the steering is too stiff, install lighter springs.

Tools needed:

5mm allen key
Flathead screwdriver

Step 1: Remove the PowerCarve Lockdown Screw (2), and lift off the entire PowerCarve Housing (4).

Step 2: Pry off the Steering Spring Cover (9) with a flathead screwdriver, and remove the existing Steering Springs and Steering Stop Pin Cap (10).

Step 3: Load the new Steering Springs onto the Stop Pin Cap (10).

Step 4: Reinstall the springs and cap into the PowerCarve Housing (4). Refer to the diagram to ensure that the stronger spring is on the correct side for the left and right skates.

Step 5: Replace the Steering Spring Cover (9), and reinstall the PowerCarve Housing (4) back onto the skate. Ensure that Steering Stop Pin (3) goes into the Stop Pin Cap (10) when you reinstall the assembly.

You may need to readjust your PowerCarve Neutral Position.

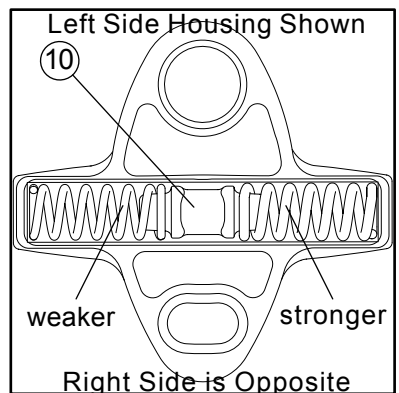
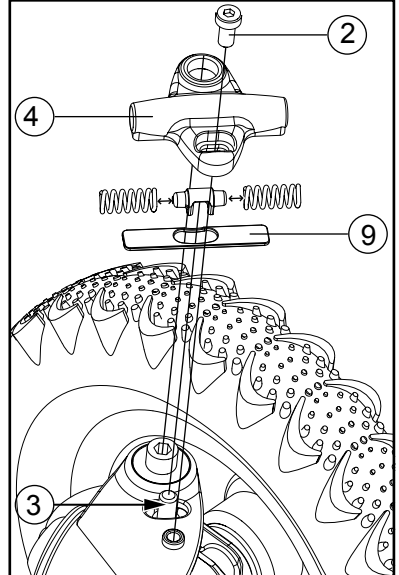

CROSSKATE™

Crosskate Inc.
13R Bessom St.
Marblehead, M.A. 01945
1.877.CROSSK8



WWW.CROSSKATE.COM