

# Crosskate 616 Backcountry™ Brakeline Replacement Instructions

Please refer to the Owner's Manual that came with your skates for other important mechanical, safety, and user information.



The Brakeline Replacement Kit consists of two (2) preassembled brakelines and cable-end crimps. Install both Brakelines at the same time to ensure proper braking performance.

If you need additional support, call Crosskate: 877.CROSSK8

**Read all instructions carefully before you begin!**

## Tools Required:

- Hex Keys: 2mm, 3mm, 4mm
- 10mm wrench
- Pliers

## Brakeline Removal

### (tools required)

1. Disconnect ratchet clasp from strap on boot.
2. Remove ratchet clasp (4mm hex key and 10mm wrench or pliers) and cable end-crimp (pliers).
3. Remove the 3 brake disc screws and the rear wheel screw (3mm hex key).
4. Remove rear wheel (you can leave the brake-disc on the axle).
5. Slip brake cable out of the ends of the brake arms.
6. Pull brake line assembly off of skate, and discard. Cut the cable if it is not already severed. **NOTE: You will not need any of the old parts!**

## Brakeline Installation

### (tools required)

1. Slip cable into arms w/spring in between (like the old one was). Make sure the cable-end and noodle are well seated in the brake arms.
2. Insert cable housing into cable-stop on the frame and pull the aluminum cable-crimp forward to the other side of the cable-stop so that the housing and cable-crimp sandwich the cable stop.

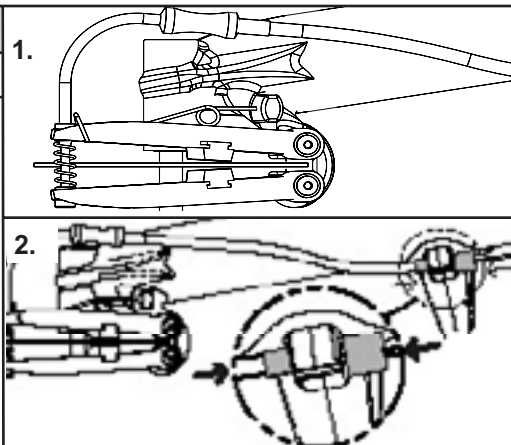

Instructions Continued on Back...

# Crosskate 616 Backcountry™ Brakeline Replacement Instructions

## Brakeline Installation

### (tools required)

#### ...Continued from Front

3. Thread cable through the hole in the frame and around pulley (use a small allen-key or pen to poke cable up around the front of the pulley).

4. Thread the cable under the metal finger that covers the top of the pulley so that the cable points back toward the boot.

5. Reinstall rear wheel and brake disc:

- Slide wheel on and position brake-disc (**disc must not be pinched between wheel and frame**).
- Start rear wheel screw until finger tight.
- Install brake disc screws (3mm hex key).
- Tighten rear wheel screw (4mm hex key).

6. Using the brake offset screw, center the brakes (2mm hex key). The wheel should spin freely with no tension in the brake cable.

7. The new brake cable has two kinks near the end. Position the cable between the clasp and washer and install ratchet clasp at the kink closest to the end of the cable (4mm hex key and 10mm wrench or pliers). The nut must be very tight for the cable to be secure!

8. Slide the new cable end-crimp onto the cable and crush it with pliers.

9. Adjust brakes: Coarse-adjust with ratchet clasp, fine-adjust with barrel in noodle.



**10. Test ride in a SAFE PLACE!**

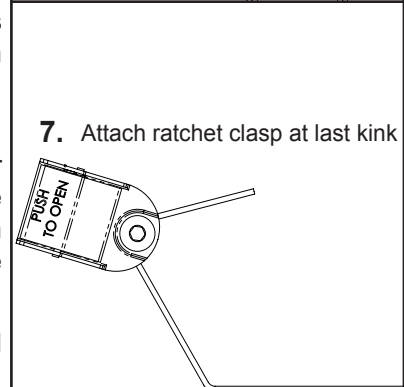
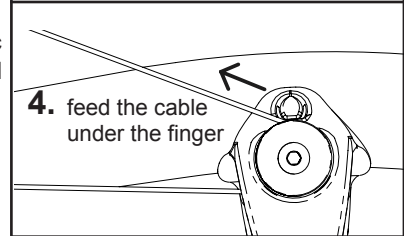
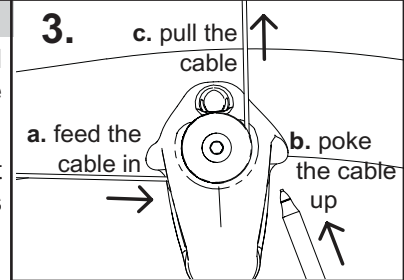

**CROSSKATE™**

Crosskate Inc.  
13R Bessom St.  
Marblehead, M.A. 01945  
1.877.CROSSK8



WWW.CROSSKATE.COM